

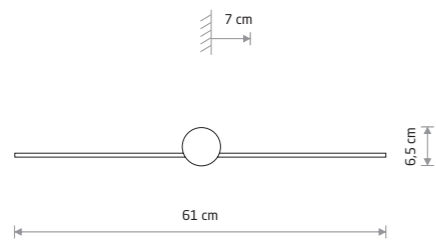

PIN LED S 8127



PIN LED S
painted aluminum, plastic PC

■ 8127



PIN LED M 8128

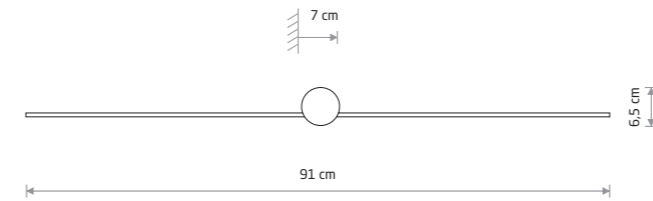

PIN LED M
painted aluminum, plastic PC

■ 8128



PIN LED L 8130

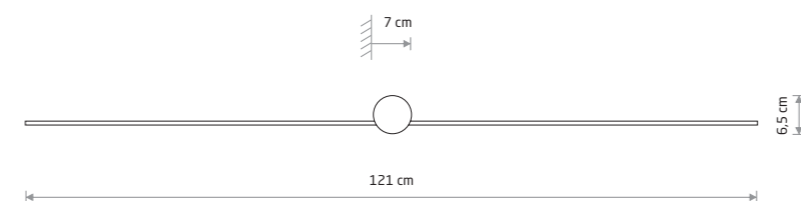

PIN LED L
painted aluminum, plastic PC

■ 8130



Item No.	Power	Colour temp.	Luminous flux	Beam angle	Colour Rendering Index (CRI)	Input	Safety type	Power factor	Ingress protection	Lifetime
8127	6W LED	4000K	280 lm	120°	≥80	~220-230 V, 50/60 Hz	☐	>0.9	IP44	30000h
8128	10W LED	4000K	500 lm	120°	≥80	~220-230 V, 50/60 Hz	☐	>0.9	IP44	30000h
8130	15W LED	4000K	700 lm	120°	≥80	~220-230 V, 50/60 Hz	☐	>0.9	IP44	30000h